

CASH VALVES CRYOGENIC VALVES AND CONTROLS

G-60 PRESSURE REDUCING OR PRESSURE BUILD-UP SERVICE

Construction

Threaded ends; bronze body, spring chamber, diaphragms and trim; stainless steel pressure spring and body seat; PTFE seat and gaskets; stainless steel bolts. Closing cap over screw provided.

Also available with all system exposed internal parts in stainless steel. All parts are commercially cleaned for cryogenic service. Also available with BSP threads.

Note: Also available in stainless steel and special construction for hi-purity service. Contact your sales representative.

Temperature rating: +150°F to -320°F (339K to 78K)
 Maximum initial pressure: 600 psi (42.18 kg/cm²)

REDUCED PRESSURE RANGES

Valve size		Maximum working ranges	
Inches	(mm)	psi	(kg/sq cm)
1/4 & 3/8	[8 & 10]	5-30	[0.35-2.11]
		15-65	[1.05-4.57]
		30-110	[2.11-7.73]
		75-200	[5.27-14.06]
		100-400*	[7.03-28.12*]
1/2	[15]	0-7	[0-0.49]
		5-70	[0.35-4.92]
		50-150	[3.52-10.55]
		50-250	[3.52-17.58]
		200-500	[14.06-35.16]
3/4	[20]	0-10	[0-0.70]
		5-75	[0.35-5.27]
		50-200	[3.52-14.06]
		100-600*	[7.03-42.18]
1	[25]	10-50	[0.70-3.52]
		50-200	[3.52-14.06]
		100-600*	[7.03-42.18]
1 1/4 & 1 1/2	[32 & 40]	5-15	[0.35-1.05]
		10-50	[0.70-3.52]
		30-75	[2.11-5.27]
		50-120	[3.52-8.44]
		75-150	[5.27-10.55]
		100-400*	[7.03-28.12]

* **Note:** higher ranges are attained by modifying standard valve and/or using a different pressure spring. Contact your sales representative.

DIMENSIONS

Size		Dimensions						Shipping weight	
inches	(mm)	A		B		C		lbs	(kgs)
		inches	(mm)	inches	(mm)	inches	(mm)		
1/4	[8]	4	[101.60]	6 5/8	[168.28]	2 3/16	[55.55]	9	[4.05]
3/8	[10]	4	[101.60]	6 5/8	[168.28]	2 3/16	[55.55]	9	[4.05]
1/2	[15]	4 3/4	[120.65]	7 7/8	[193.68]	2 5/16	[58.72]	16	[7.20]
3/4	[20]	5 5/8	[142.88]	10	[254.00]	2 7/8	[66.68]	24	[10.80]
1	[25]	6 1/2	[165.10]	10 3/4	[273.05]	2 7/8	[73.03]	35	[15.75]
1 1/4	[32]	8	[203.20]	12 5/16	[312.74]	3 3/16	[90.49]	63	[28.35]
1 1/2	[40]	8	[203.20]	12 5/16	[312.74]	3 3/16	[90.49]	63	[28.35]

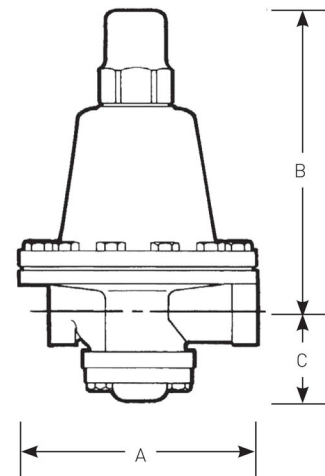

CASH VALVES CRYOGENIC VALVES AND CONTROLS

TYPE G60 SELECTION GUIDE

Example:	G60Z	A	W	S	S	Z	Z	B	H	00	-	E	1
Model													
G60Z	G60 w/ bronze body												
G60G	G60 w/ 316 stainless steel body												
Valve size													
A	1/4"											E	1"
B	3/8"											F	1 1/4"
C	1/2"											G	1 1/2"
D	3/4"												
Service													
C	Cryogenic service												
F	Final line gas (O ₂ clean but not used in cryo service)												
Body/connection style													
S	Side inlet/side outlet - straight thru w/ NPT connections												
Spring chamber style													
S	Standard												
C	w/ pressure screw cap												
D	w/ pressure screw cap and differential connection												
V	Vented												
W	Vented w/ pressure screw cap												
Spring chamber material													
Z	Bronze												
G	316 stainless steel												
Diaphragm material													
B	Buna-N (final line gas)												
Z	Bronze (cryo)												
G	316 stainless steel (cryo)												
L	Buna-N w/ Teflon liner (final line gas)												
Seat material													
T	Teflon (cryo)												
V	Viton (final line gas)												
Pressure screw style													
S	Standard												
Variation													
01	Standard (303 stainless steel trim) (303 SST seat ring, 303 SST pusher post button, 303 SST pusher post, 303 SST guide bushing, 303 SST piston and 316 SST bottom cap)												
31	Brass trim (303 SST seat ring, brass pusher post button, brass pusher post, 303 SST guide bushing, brass piston and bronze bottom cap)												
Design revision													
(-)	Indicates original design												
Spring material													
E	Stainless steel												
Spring range													
	Refer to table below												

STANDARD SPRING RANGES (psig)

Spring Material	Size	1	2	3	4	5	6
SST	1/4", 3/8"	5 - 30	15 - 65	30 - 110	75 - 200	100 - 400	100 - 600
	1/2"	0 - 7	5 - 70	50 - 150	50 - 250	100 - 400	200 - 500
	3/4"	0 - 10	5 - 75	50 - 200	100 - 400	100 - 600	----
	1"	10 - 50	50 - 200	100 - 400	100 - 600	----	----
	1 1/4", 1 1/2"	5 - 15	10 - 50	30 - 75	50 - 120	75 - 120	100 - 400