

CASH VALVES CRYOGENIC VALVES AND CONTROLS

E-55 PRESSURE REDUCING, PRESSURE BUILD-UP OR FINAL-LINE GAS SERVICE

Construction - for pressure reducing or pressure build-up service

Bronze body, spring chamber, trim; stainless steel body seat and pressure spring; PTFE seat, O-rings and bottom plug gasket; Monel® diaphragms and strainer screen; stainless steel bolts. All parts are commercially cleaned for cryogenic service. Also available with BSP threads.

Size range: 1¼", 1½", 2" (32, 40, 50 mm)
 Temperature rating: +150°F to -320°F (339K to 78K)
 Maximum initial pressure: 400 psi (28.12 kg/cm²)

Construction - for final-line gas service

Bronze body, spring chamber and trim; stainless steel body seat and pressure spring; FKM seat disc and PTFE bottom plug gasket; FKM O-ring and neoprene diaphragm with FKM liner; Monel® strainer screen. All parts are commercially cleaned for oxygen service. Also available with BSP threads.

Size range: ½", ¾", 1", 1¼", 1½", 2" (15, 20, 25, 32, 40, 50 mm)
 Temperature rating: +150°F to 0°F (339K to 255K)
 Maximum initial pressure: 400 psi (28.12 kg/cm²)

Note: Specification for final-line gas service is not for use on cold gas or liquid (less than 0°F).



REDUCED PRESSURE RANGES

| Valve size | | Maximum working ranges | |
|--------------|--------------|------------------------|---------------|
| Inches | (mm) | psi | (kg/sq cm) |
| ½", ¾", 1" | (15, 20, 25) | 10-35 | (0.70-2.46) |
| | | 20-75 | (1.41-5.27) |
| | | 75-125 | (5.27-8.79) |
| | | 125-175 | (8.79-12.30) |
| | | 75-250 | (5.27-17.58) |
| 1¼", 1½", 2" | (32, 40, 50) | 20-70 | (1.41-4.92) |
| | | 50-150 | (3.52-10.55) |
| | | 75-200 | (5.27-14.06) |
| | | 150-300 | (10.55-21.09) |

DIMENSIONS

| Size | | Dimensions | | | | | | Shipping weight | |
|--------|------|------------|----------|--------|----------|--------|---------|-----------------|-------|
| | | A | | B | | C | | | |
| inches | (mm) | inches | (mm) | inches | (mm) | inches | (mm) | lbs | (kgs) |
| ½ | (15) | 4 | (101.6) | 7¼ | (184.15) | 2¼ | (57.15) | 6 | (2.7) |
| ¾ | (20) | 4 | (101.6) | 7¼ | (184.15) | 2¼ | (57.15) | 6 | (2.7) |
| 1 | (25) | 4 | (101.6) | 7¼ | (184.15) | 2¼ | (57.15) | 6 | (2.7) |
| 1¼ | (32) | 5⅝ | (142.88) | 11⅞ | (282.58) | 3¼ | (82.55) | 17 | (7.7) |
| 1½ | (40) | 5⅝ | (142.88) | 11⅞ | (282.58) | 3¼ | (82.55) | 17 | (7.7) |
| 2 | (50) | 5¾ | (146.05) | 11⅞ | (288.93) | 2⅞ | (73.03) | 17 | (7.7) |

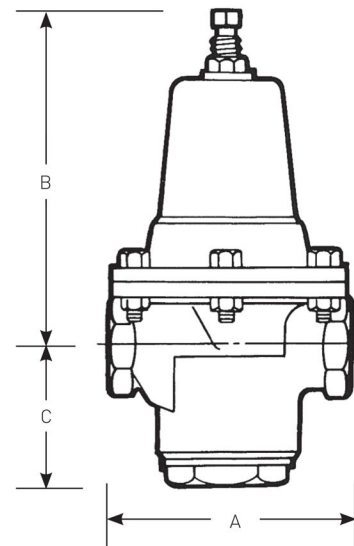

CASH VALVES CRYOGENIC VALVES AND CONTROLS

TYPE E-55 SELECTION GUIDE

| Example: | E55 | C | C | S | G | T | 01 | - | E | 1 | |
|------------------------------------|---|----------|--------|---|---|---|----|---|---|---|--|
| Model | | | | | | | | | | | |
| E55 | E-55 valve w/ bronze body and spring chamber | | | | | | | | | | |
| Valve size | | | | | | | | | | | |
| C | 1/2" | F | 1 1/4" | | | | | | | | |
| D | 3/4" | G | 1 1/2" | | | | | | | | |
| E | 1" | H | 2" | | | | | | | | |
| Service | | | | | | | | | | | |
| C | Cryo (1 1/4" - 2") | | | | | | | | | | |
| F | Final line gas (all sizes) | | | | | | | | | | |
| Body style/connection style | | | | | | | | | | | |
| S | Side inlet/side outlet - straight thru w/ NPT connections | | | | | | | | | | |
| B | Side inlet/side outlet - straight thru w/ BSPT connections | | | | | | | | | | |
| C | Side inlet/side outlet - straight thru w/ NPT connections (enlarged port) 1" E-55 only | | | | | | | | | | |
| D | Side inlet/side outlet - straight thru w/ BSPT connections (enlarged port) 1" E-55 only | | | | | | | | | | |
| Diaphragm material | | | | | | | | | | | |
| G | 316 SST (cryo) (1 1/4" - 2") | | | | | | | | | | |
| N | Neoprene w/ Viton diaphragm liner (final line gas) | | | | | | | | | | |
| L | Neoprene w/ Teflon diaphragm liner (final line gas) | | | | | | | | | | |
| Seat material | | | | | | | | | | | |
| T | Teflon (cryo) | | | | | | | | | | |
| V | Viton (final line gas) | | | | | | | | | | |
| Variation | | | | | | | | | | | |
| 01 | Standard | | | | | | | | | | |
| Design revision | | | | | | | | | | | |
| (-) | Indicates original design | | | | | | | | | | |
| Spring material | | | | | | | | | | | |
| E | SST | | | | | | | | | | |
| Spring range | Refer to table below | | | | | | | | | | |

STANDARD SPRING RANGES (psig)

| Spring Material | Size | 1 | 2 | 3 | 4 | 5 |
|-----------------|--------------------|---------|----------|----------|-----------|-----------|
| SST | 1/2", 3/4", 1" | 10 - 35 | 20 - 75 | 75 - 125 | 125 - 175 | 75 - 250 |
| | 1 1/4", 1 1/2", 2" | 20 - 70 | 50 - 150 | ---- | 75 - 200 | 150 - 300 |